

Timing Belt Conveyors ZRF-P 2010

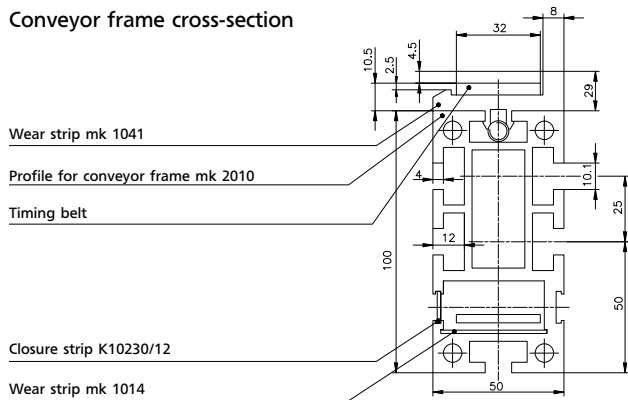

Conveyor frame cross-section





Timing Belt Conveyor System ZRF-P 2010 is designed for the transport of heavy pallets or structurally rigid products. Due to the positive engagement of the belt teeth and the sprockets, the belts are synchronized and the conveyors are ideal for cycle operation applications. The wear strips of high molecular polyethylene, on which the timing belt runs and is guided, are character-

istic of this conveyor system. The wear strips have a low coefficient of friction, and provide good wear resistance over a broad temperature range (continuous to 65° C, or 149° F). A further design feature is the belt return, which occurs within the frame profile itself. This is a safety benefit, and also serves to protect the belt. In addition, T-slots are accessible on three sides on the

profile frame for the attachment of stands, side rails, sensors and stops (10 mm opening). A variety of belt coatings are available, providing further options for specific product and project related handling applications. In combination with the wide and varied drive options, System ZRF-P 2010 serves as a key element for the manufacture of larger automation and material handling systems.

ZRF-P 2010 AA

Timing belt conveyor with head drive without motor

B20.10.350

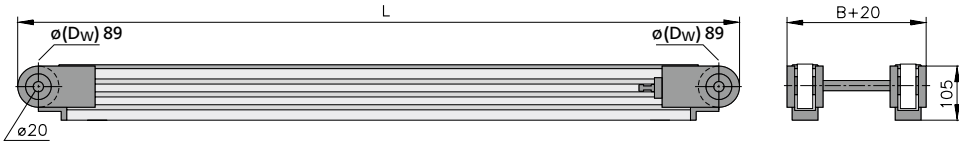

Wear strip options see page 155

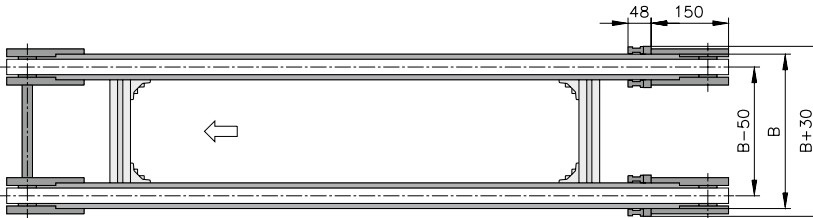

Drive version AA is primarily used where multiple lanes are to be slave driven, either parallel or in-line, using a single drive motor. Depending on the requirement, the conveyor is designed either with a hollow shaft or with a connecting shaft with shaft journal ($\phi 20$ mm, usable length 34 mm, incl. shaft key DIN 6885). Use of fixtured timing belts is not possible with this drive version.

	Dimensions – technical information	Notes
Conveyor length L	between 500-6000 mm	any increment possible
Conveyor width B	200 to 1000 mm	
Timing belt width	32 mm	see page 158
Drive and speed	to 60 m/min (200 ft/min) higher on request	see chart on page 12
Stands and side rails		see from page 262
Load capacity	total load to 250 kg (550 lbs) section load to 100 kg (220 lbs) /m	higher on request

ZRF-P 2010 AC

Timing belt conveyor with head drive standard

B20.10.351

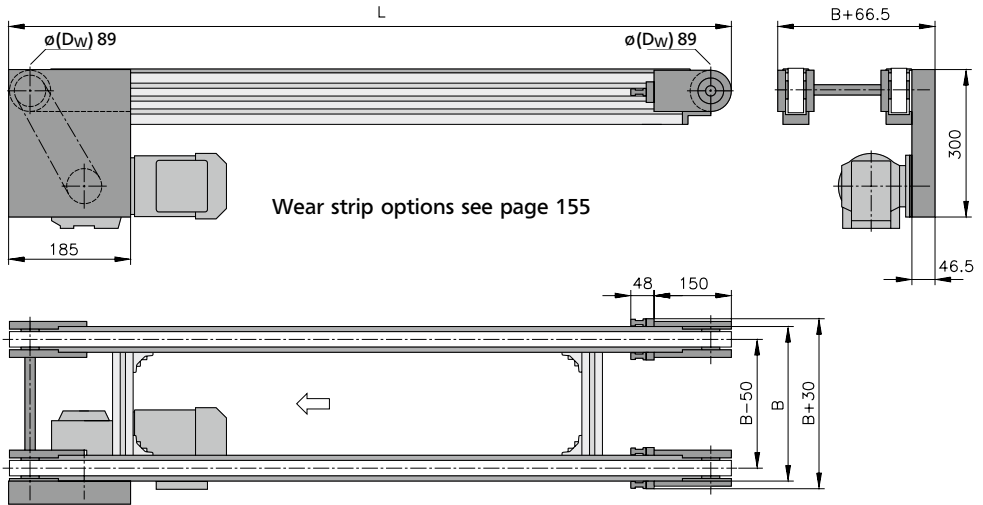

Use of high torque motors is possible due to positive drive system. Use of fixtured timing belts is not possible with this drive version.

	Dimensions – technical information	Notes
Conveyor length L	between 500-6000 mm	any increment possible
Conveyor width B	200 to 1000 mm	
Timing belt width	32 mm	see page 158
Drive location	discharge side left/right below	
Drive and speed	to 60 m/min (200 ft/min) higher on request	see chart on page 12
Stands and side rails		see from page 262
Load capacity	total load to 250 kg (550 lbs) section load to 100 kg (220 lbs) /m	higher on request

ZRF-P 2010 AF

Timing belt conveyor with head drive, direct

B20.10.357

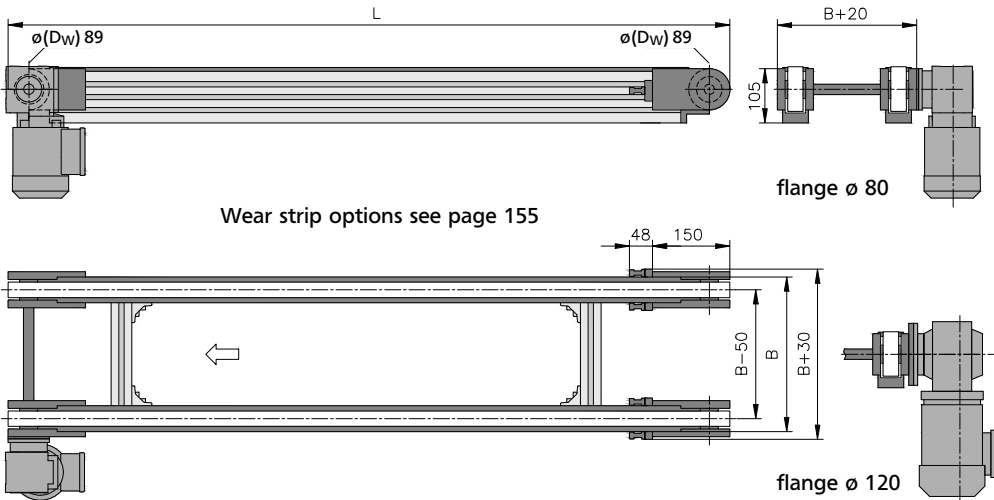

By placing the motor directly onto the drive shaft, this drive version minimizes not only the space \varnothing \downarrow \uparrow red at the drive yet also the number of moving parts and maintenance requirements. Use of fixtured timing belts is not possible with this drive version.

	Dimensions – technical information	Notes
Conveyor length L	between 500-6000 mm	any increment possible
Conveyor width B	200 to 1000 mm	
Timing belt width	32 mm	see page 158
Drive location	discharge side left/right	
Drive and speed	to 60 m/min (200 ft/min) higher on request	see chart on page 12
Stands and side rails		see from page 262
Load capacity	total load to 250 kg (550 lbs) section load to 100 kg (220 lbs) /m	higher on request

ZRF-P 2010 AS

Timing belt conveyor with outside head drive

B20.10.355

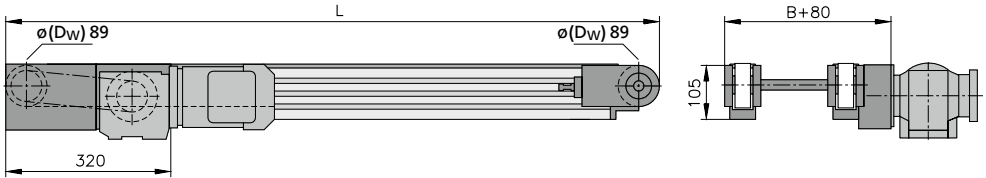

Wear strip options see page 155

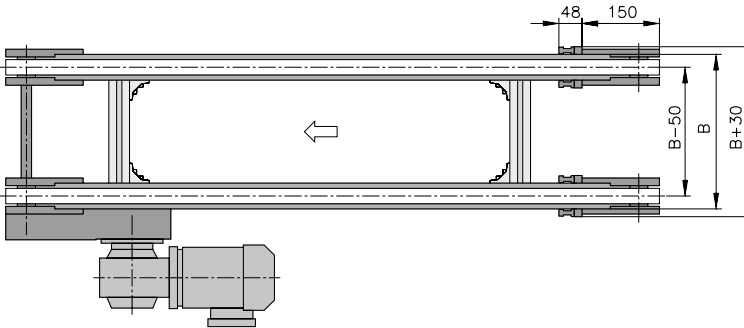

The overall height of the drive assembly is held to an absolute minimum. Use of fixtured timing belts is not possible with this drive version.

	Dimensions – technical information	Notes
Conveyor length L	between 700-6000 mm	any increment possible
Conveyor width B	200 to 1000 mm	
Timing belt width	32 mm	see page 158
Drive location	discharge side left/right	
Drive and speed	to 60 m/min (200 ft/min) higher on request	see chart on page 12
Stands and side rails		see from page 262
Load capacity	total load to 250 kg (550 lbs) section load to 100 kg (220 lbs) /m	higher on request

ZRF-P 2010 AQ

Timing belt conveyor with head drive, dual-strand

B20.10.354

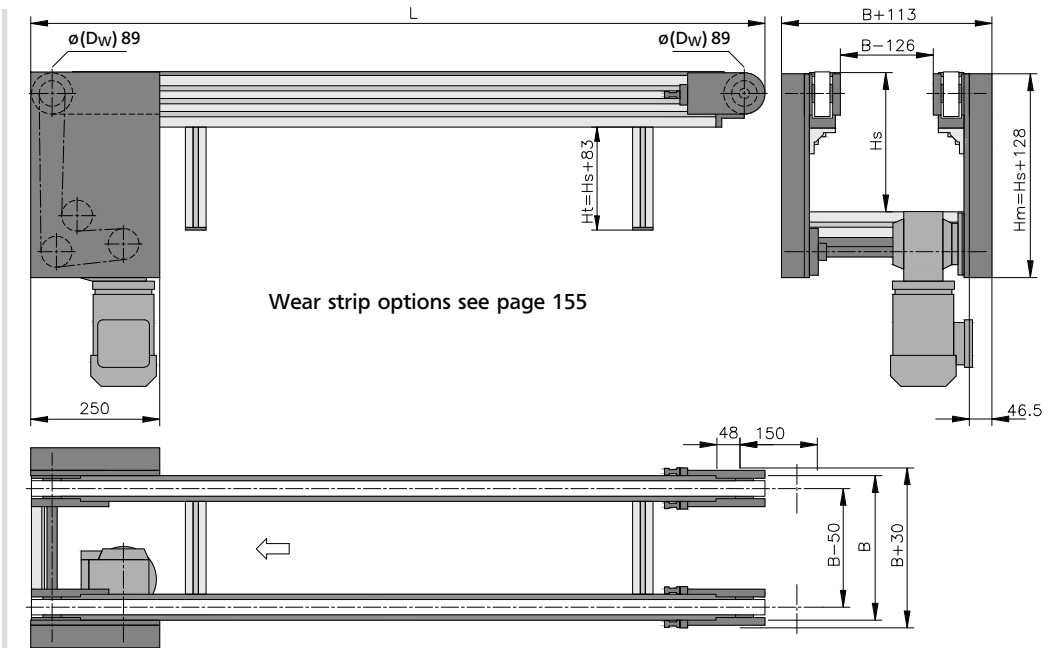

In principle, the drive concept of the AQ version is the same as for the AC version. This drive is used when the goods to be transported or the pallets require a free space between the conveyor strands. Operation with welded-on cams is not possible with this version.

	Dimensions – technical information	Notes
Conveyor length L	between 500-6000 mm	any increment possible
Conveyor width B	200 to 1000 mm	
Timing belt width	32 mm	see page 158
Drive location	discharge side left/right below	
Drive and speed	to 60 m/min (200 ft/min) higher on request	see chart on page 12
Stands and side rails		see from page 262
Load capacity	total load to 250 kg (550 lbs) section load to 100 kg (220 lbs) /m	higher on request

ZRF-P 2010 BC

Timing belt conveyor with center drive standard

B20.10.356

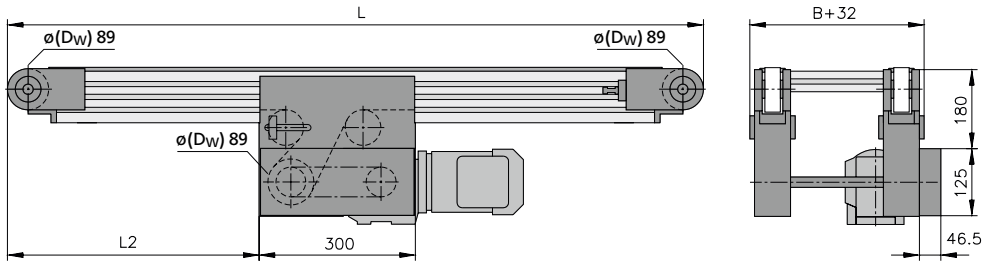

Wear strip options see page 155

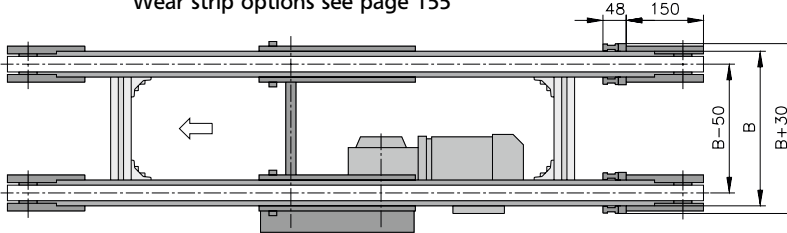

The compact design, and the ability to place the drive location anywhere along the conveyor frame (during manufacture), simplifies the integration of this conveyor into new or existing equipment. Use of timing belts with fixtures is not possible with this drive version. Use of fixtured timing belts is not possible with this drive version.

	Dimensions – technical information	Notes
Conveyor length L	between 700-6000 mm	any increment possible
Conveyor width B	200 to 1000 mm	
Timing belt width	32 mm	see page 158
Drive location	left/right below	
Drive and speed	to 60 m/min (200 ft/min) higher on request	see chart on page 12
Stands and side rails		see from page 262
Load capacity	total load to 250 kg (550 lbs) section load to 100 kg (220 lbs) /m	higher on request

ZRF-P 2010 BF

Timing belt conveyor with center drive, direct

B20.10.359

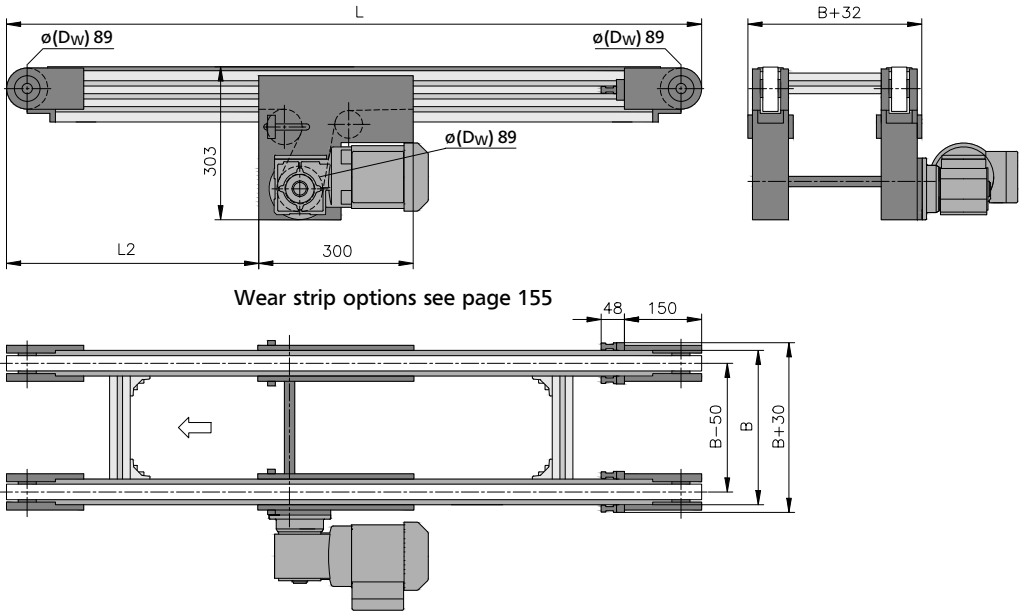

Thanks to the motor fitted directly on the drive shaft, with this drive version the spatial requirements and maintenance effort is reduced to a minimum. The compact conveyor frame structure, and the possibility of freely selecting the drive position over the entire length of the conveyor, facilitate integration of the conveyor in existing systems. The travel direction is reversible. Operation with welded-on cams is not possible with this version.

	Dimensions – technical information	Notes
Conveyor length L	between 700-6000 mm	any increment possible
Conveyor width B	200 to 1000 mm	
Timing belt width	32 mm	see page 158
Drive location	left/right below	
Drive and speed	5; 6,3; 8; 9,5; 11,5; 13,5; 15,2; 19,3; 23; 26; 36,6; 45,7 and 57 m/min	see chart on page 12
Stands and side rails		see from page 262
Load capacity	total load to 250 kg (550 lbs) section load to 100 kg (220 lbs) /m	higher on request

ZRF-P 2010

Wear strips

mk Guide- and wear strips feature low friction and high wear resistance.
The wear strips are made of PE-UHMW (PE-1000). Temperature max. 65° C (149° F).

Option A

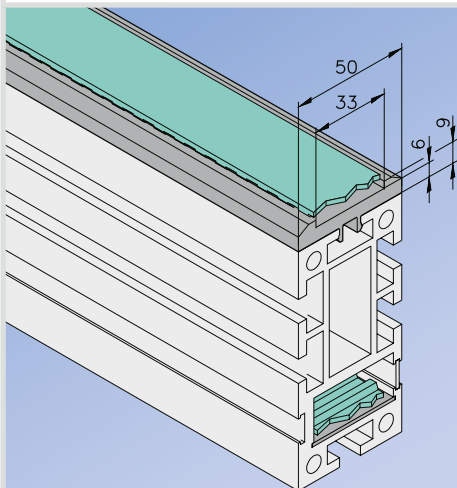

Wear strip mk 1042, 22.42.2000

Option B

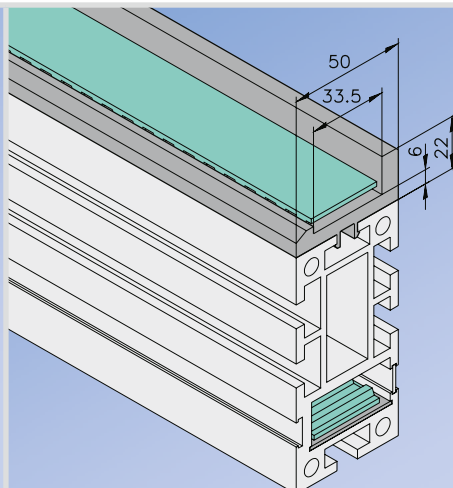

Wear strip mk 1041, 22.41.2000